

# PARIS LAVATORY PAN WITH HIGH LEVEL CISTERN - USA

The Paris lavatory pan goes very well with the original French basins with softer detailing. It is also available to use with a low level, close coupled or concealed cistern and available as an S or P-trap.

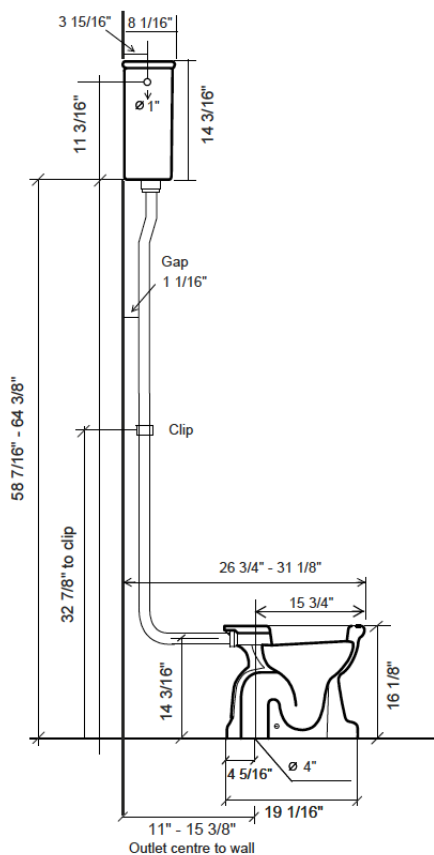

Side view with s-trap pan



Side view with p-trap pan

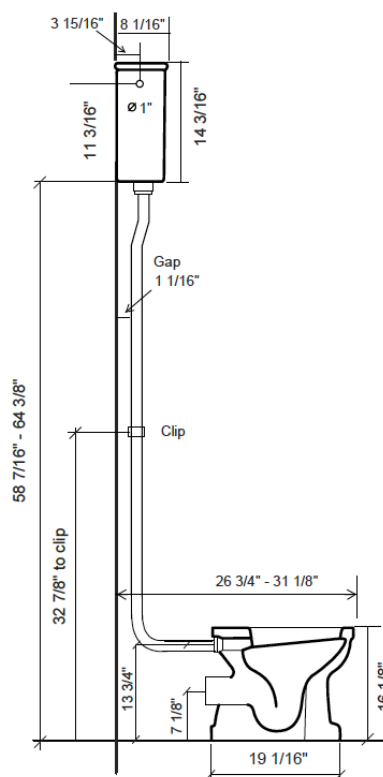

Front view

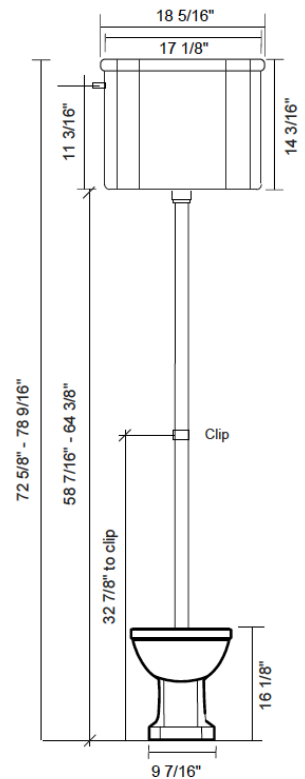

# PARIS LAVATORY PAN WITH HIGH LEVEL CISTERN - USA

(Page 2/2)

Cistern inlet pipe position diagram

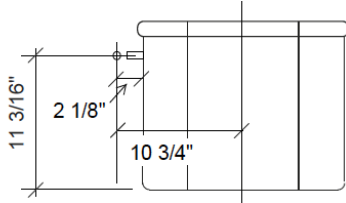

Horizontal pan connector

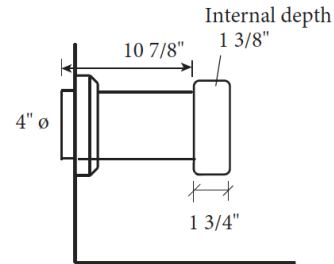

Collar for horizontal pan connector

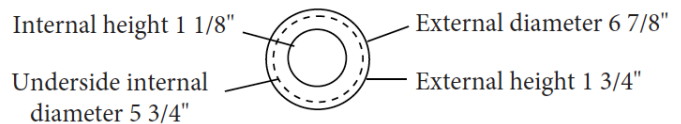

Mac 3" Pan Adaptor for US

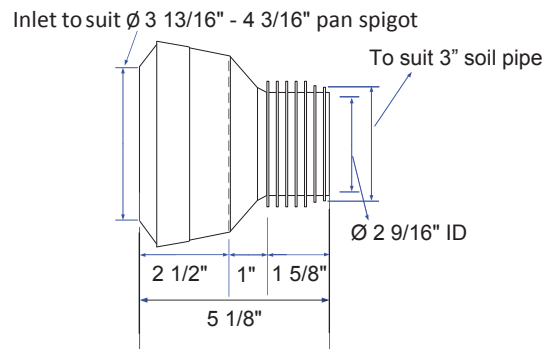

## Technical Details

Assembly/Configuration: 2 piece water closet +  
 high level cistern  
 Bowl shape: Elongated  
 Flush motion: Pull chain  
 Flush position: Right hand  
 Flush Primary Material: Brass  
 Flushing Technology: Syphonic Flush  
 Depth max: 31 1/8"  
 Height max: 78 9/16"  
 Inlet connection size: 1/2"  
 Inlet connection type: Male Threading  
 Installation type: Wall hung cistern  
 Cistern width: 18 5/16"  
 Outer Rim Shape: Elongated  
 Rim height: 16 1/8"  
 Application: Bathroom / Cloakroom  
 Water Pressure Maximum: 85.0 psi  
 Water Pressure Minimum: 20.0 psi  
 Water Pressure Recommended: 45.0psi  
 Outlet size: 4"  
 Water consumption: 1.585 USA gallons  
 Optional straight china pan connector available

## Product Notes

All dimensions are based on original specifications  
 and are subject to change and variation.